

REVISED FEB 10, 2015

- NOTES:
- 1. THIS IS REVERSE ENGINEERED FROM A USED PART TO THE BEST OF MY ABILITY. THERE IS NO WARRANTY EXPRESSED OR IMPLIED.
 - 2. MATERIAL IS NOT CRITICAL. MANY PRODUCTION MACHINES USE FREE MACHINING STEEL.
 - 3. RE-SHIM TURRET TO CORRECT HEIGHT WHEN REPLACING TURRET PLATE.

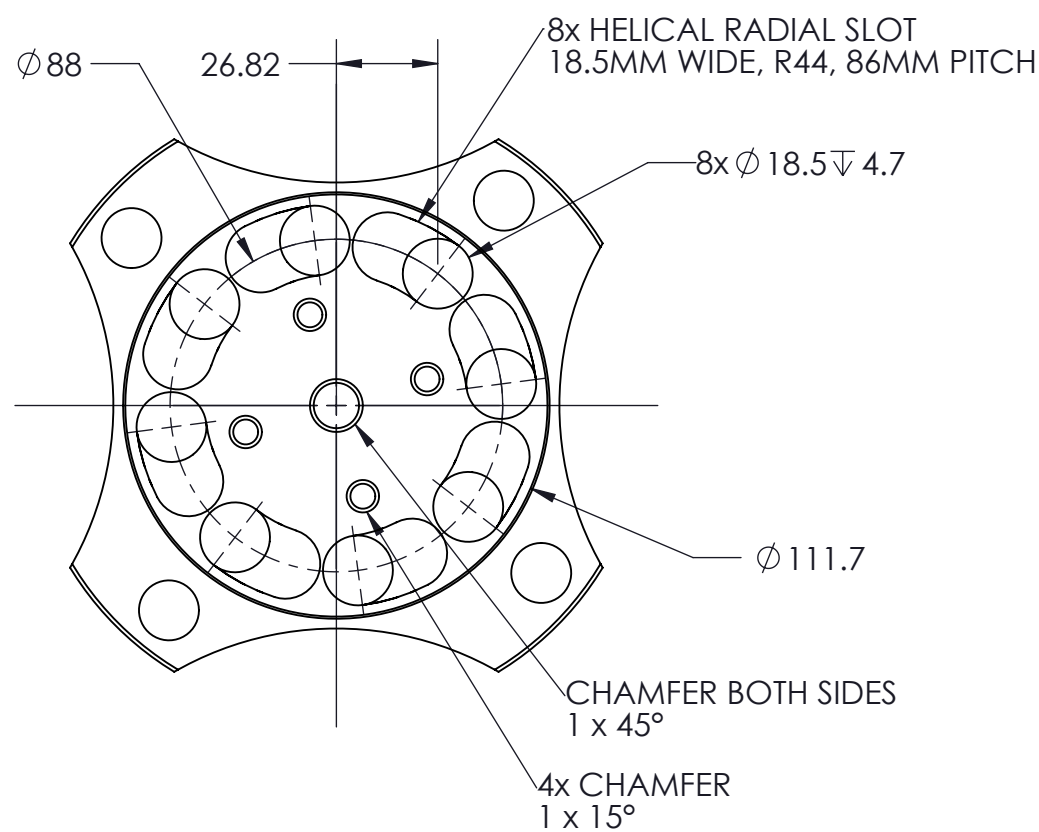
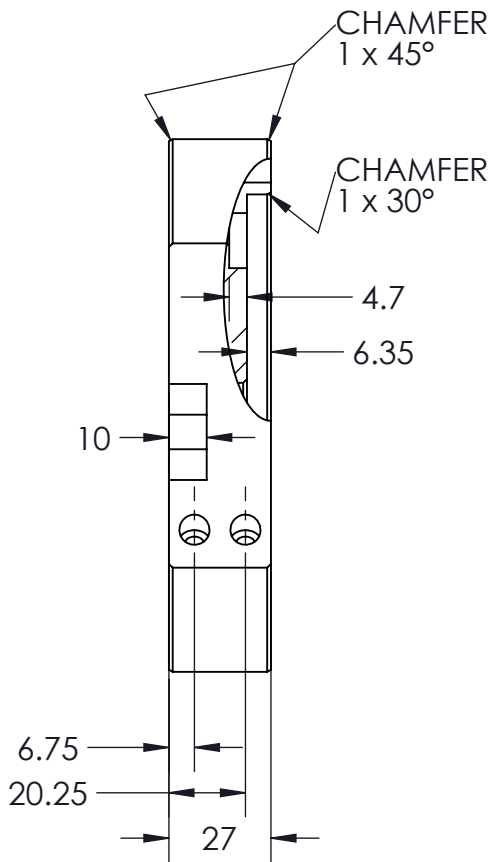
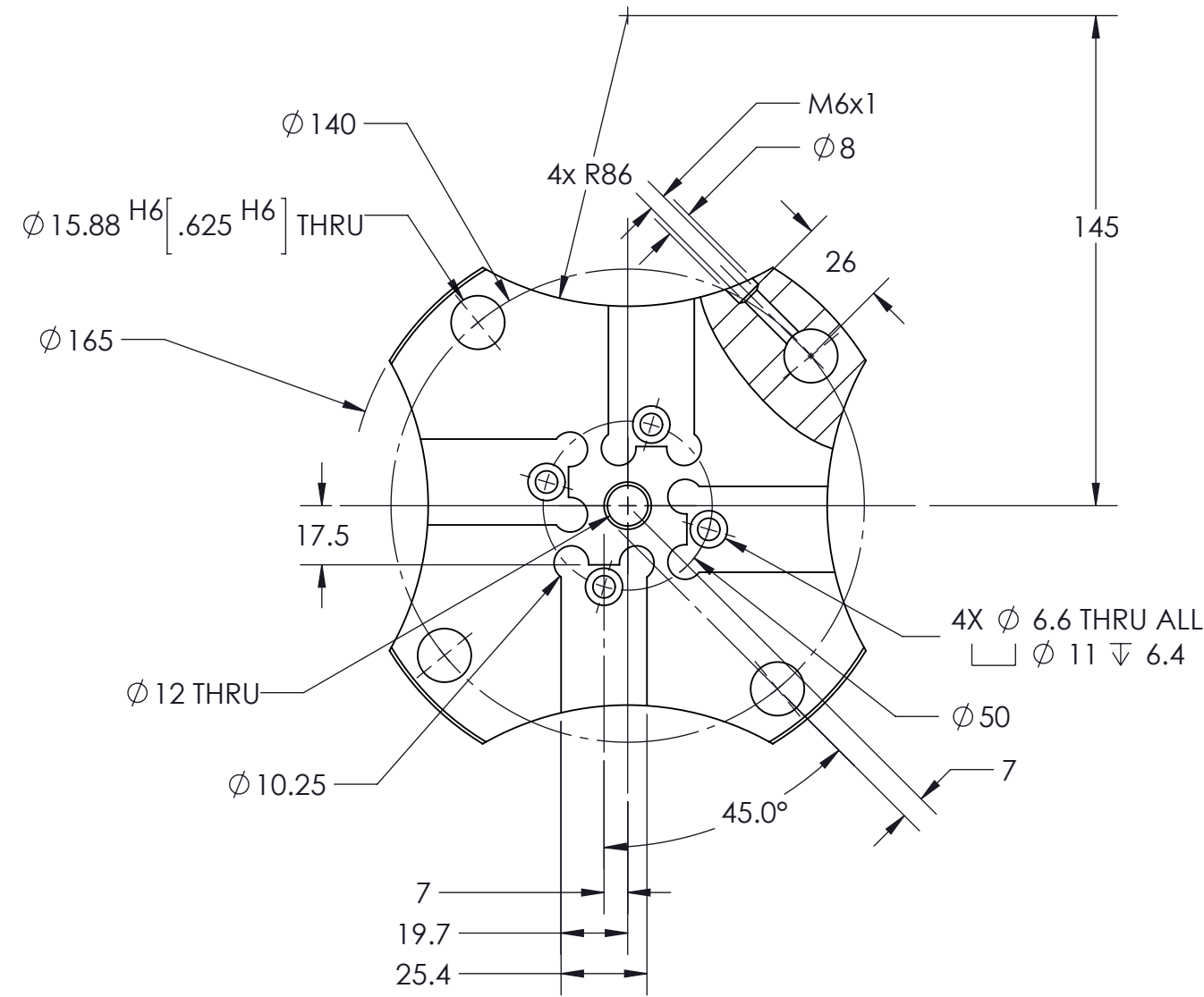

UNLESS OTHERWISE SPECIFIED:		NAME	DATE	GREGORY KAMYSZ		
DIMENSIONS ARE IN MM TOLERANCES: ANGULAR: MACH±.5 BEND ± 0.X ±0.25 0.XX ±0.10 0.XXX±0.05	DRAWN	GK	6/10/2014	TITLE: TURRET PLATE, EMCO COMPACT 6, 120		
	CHECKED					
	ENG APPR.					
	MFG APPR.					
GEOMETRIC TOLERANCING PER: ASME Y14.5M-2009	Q.A.			REV A		
MATERIAL Plain Carbon Steel	COMMENTS:					
FINISH NONE						
DO NOT SCALE DRAWING		SCALE: 1:2		WT: 2136.17		SHEET 1 OF 1

THE INFORMATION CONTAINED IN THIS
DRAWING IS NOT VERIFIED. USE AT
YOUR OWN RISK.